

ESTADOS UNIDOS DE AMERICA

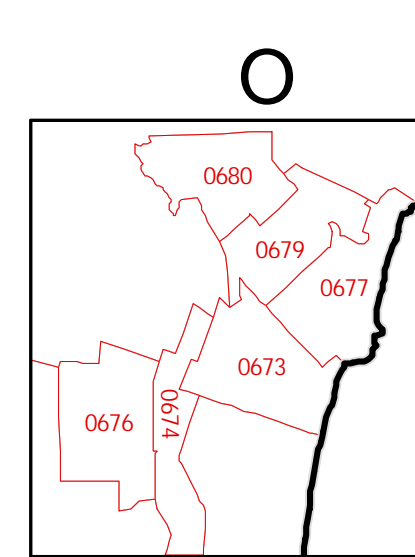
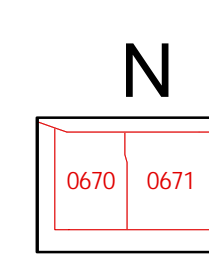
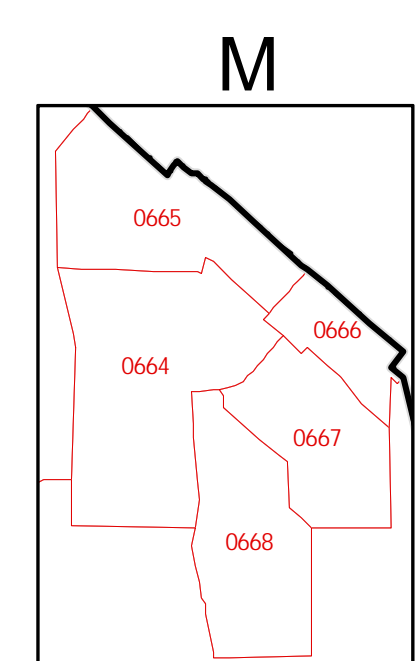
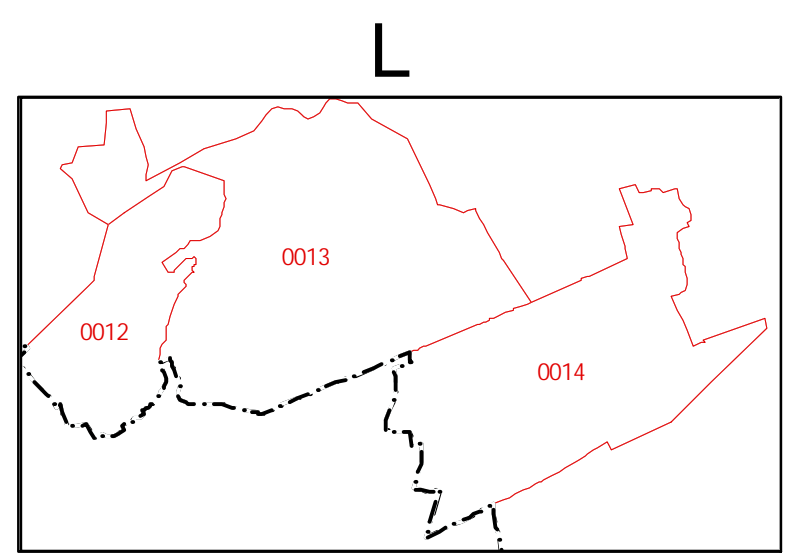
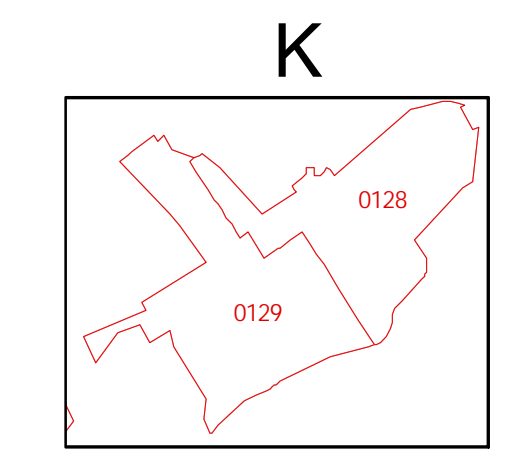
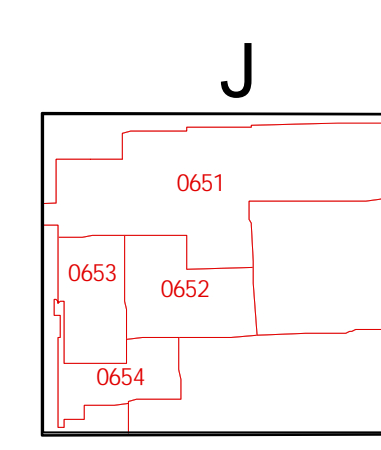
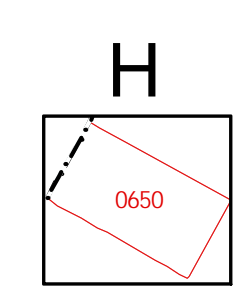
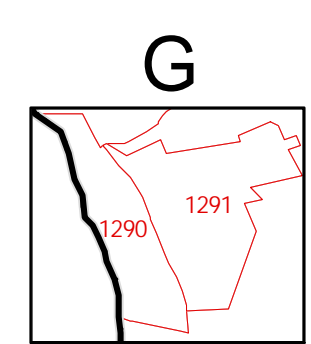
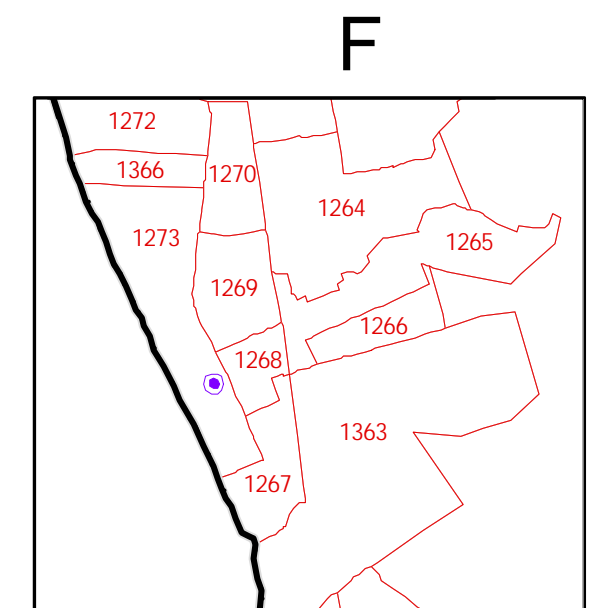
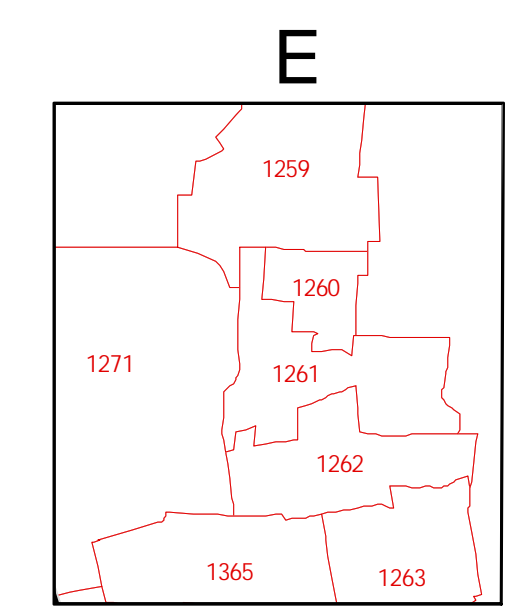
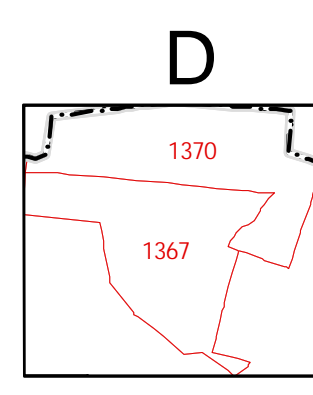
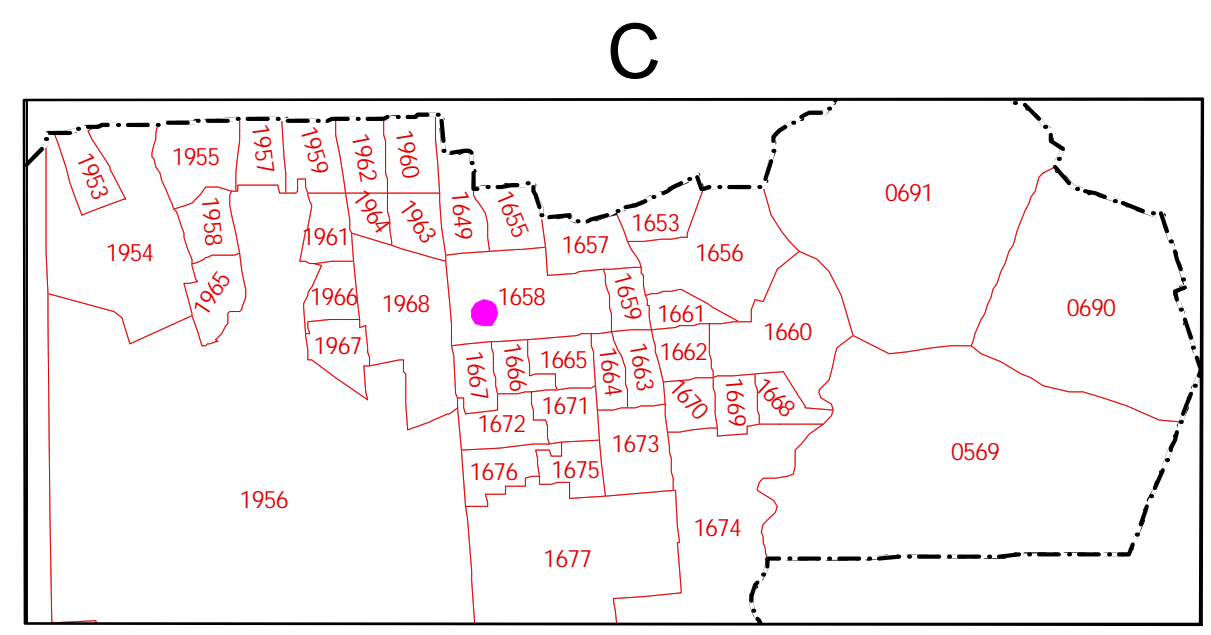
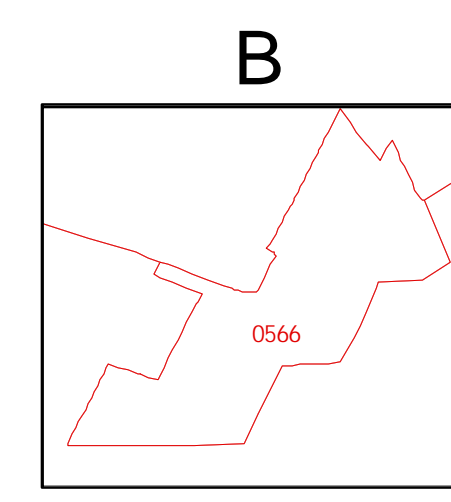
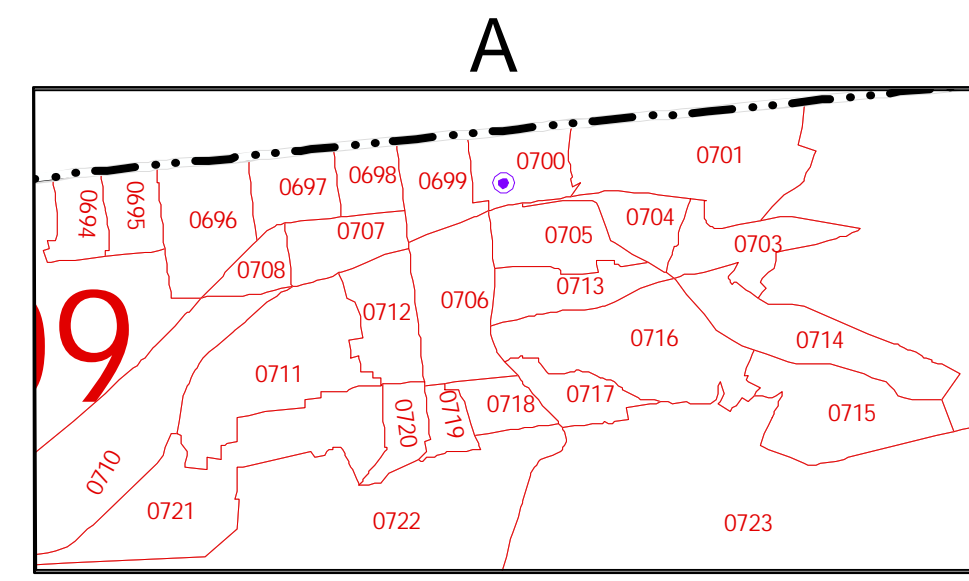
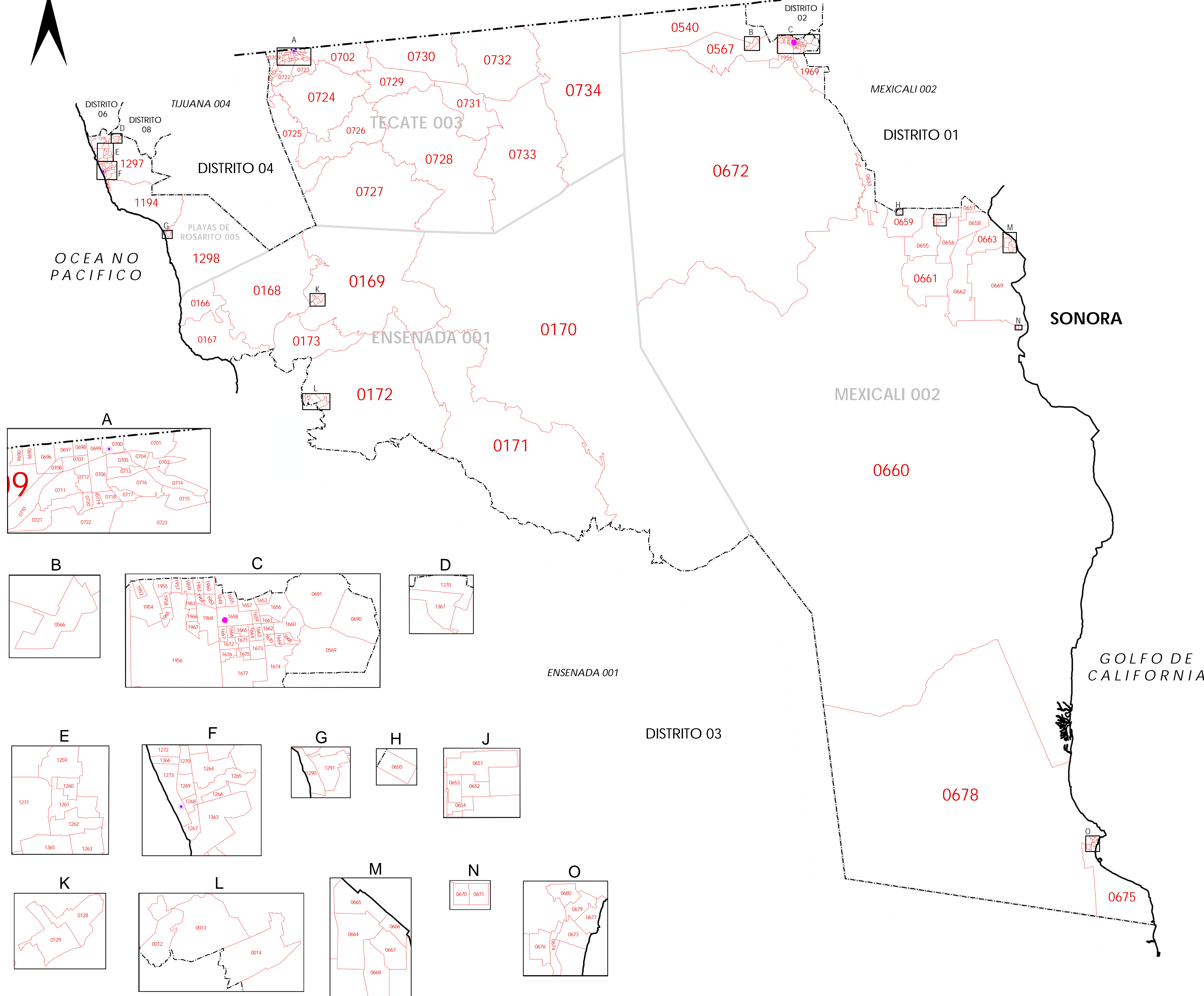
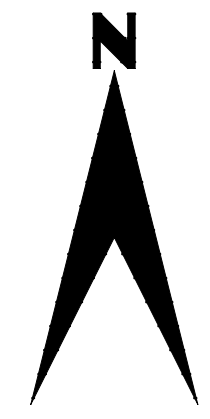

INSTITUTO NACIONAL ELECTORAL
REGISTRO FEDERAL DE ELECTORES
COORDINACIÓN DE OPERACIÓN EN CAMPO
DIRECCIÓN DE CARTOGRAFÍA ELECTORAL

SIMBOLOGÍA

LIMITES
INTERNACIONAL
ESTATAL
DISTRITAL FEDERAL
DELEGACIONAL Y/O MUNICIPAL
SECCIONAL
.....

CLAVES GEOELECTORALES
DISTRITO ELECTORAL FEDERAL 00
MUNICIPIO 000
SECCIÓN 0000

CABECERAS
CAPITAL DEL ESTADO
VOCALIA ESTATAL
CABECERA DISTRITAL
CABECERA DE MUNICIPIO

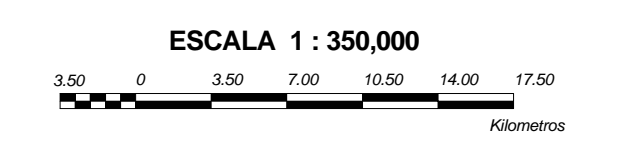
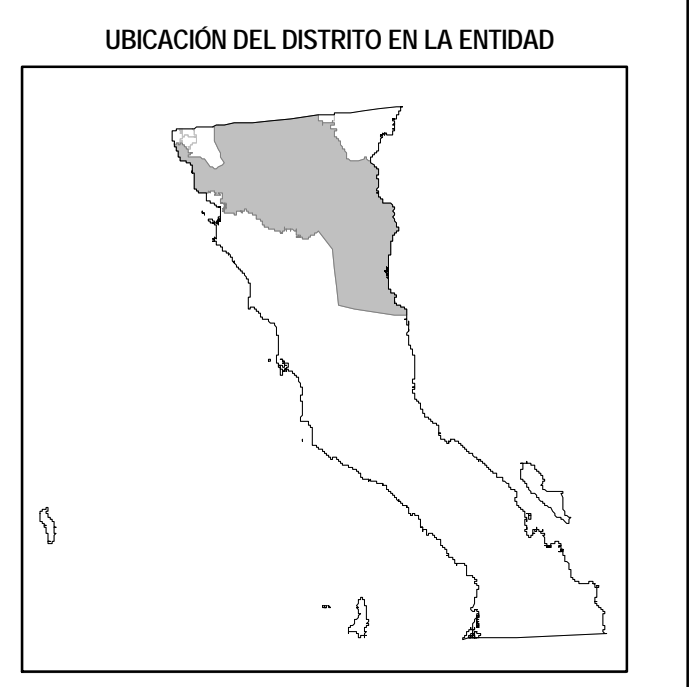
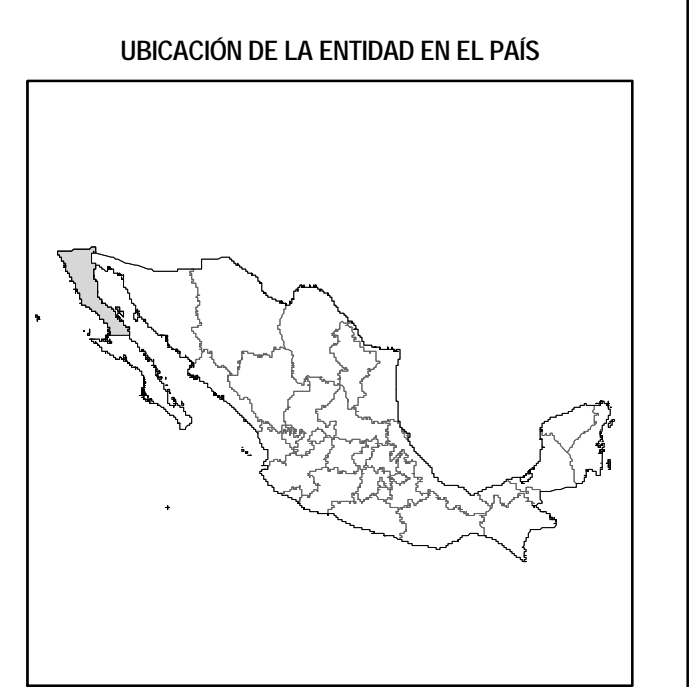

PLANO DISTRITAL SECCIONAL

IDENTIFICACIÓN ELECTORAL

ENTIDAD: BAJA CALIFORNIA 02
DISTRITO ELECTORAL FEDERAL: 07
TOTAL DE SECCIONES: 161
TOTAL DE MUNICIPIOS: 4

FECHA DE ACTUALIZACIÓN DE LA BASE DIGITAL: 15 DE MARZO DE 2017
FUENTE: R.F.E.D.C.E.