

BAJA CALIFORNIA

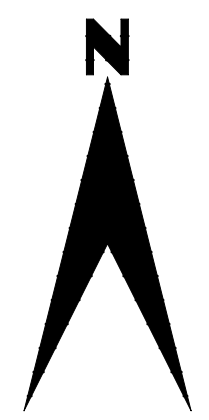

A

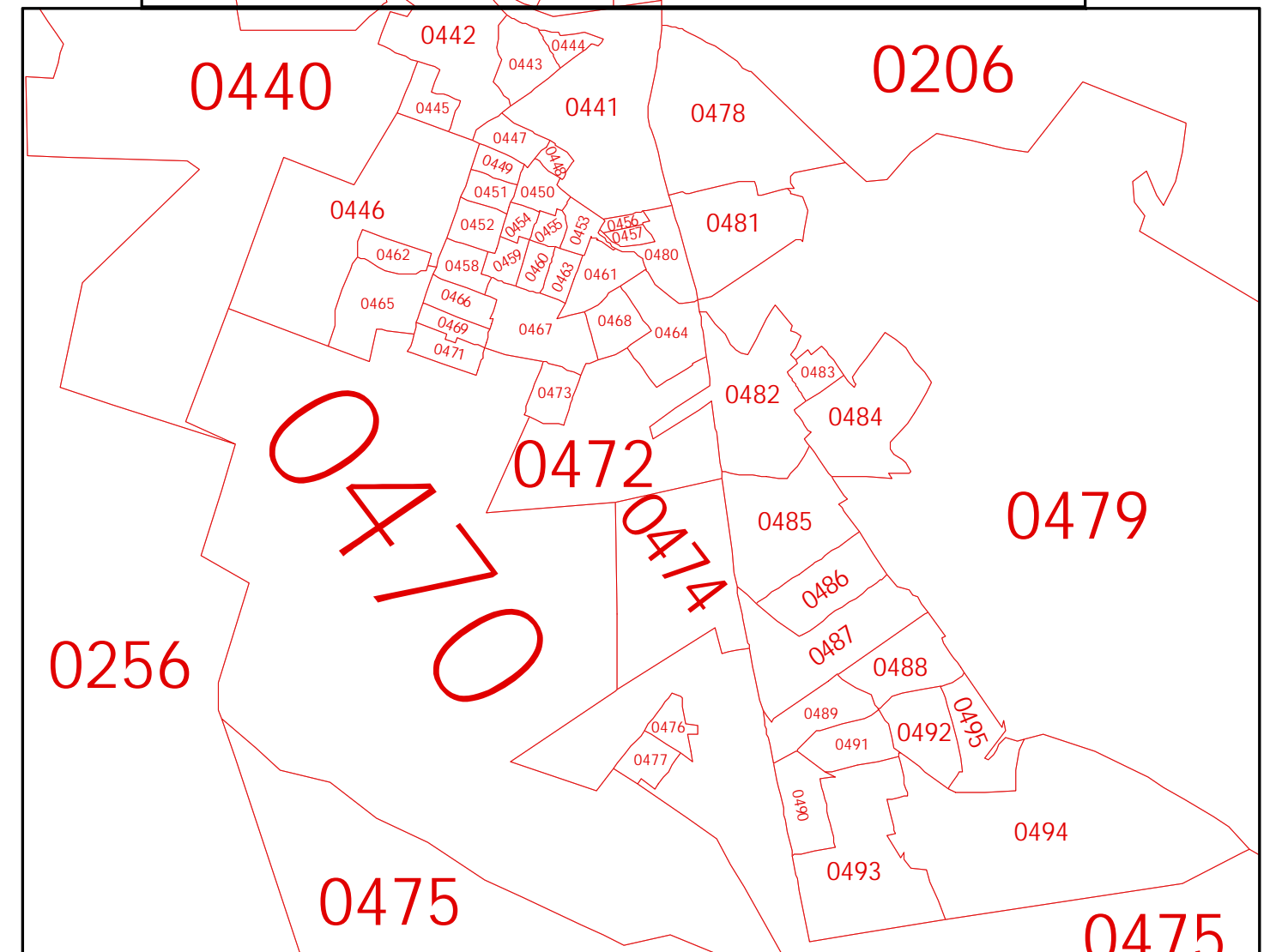
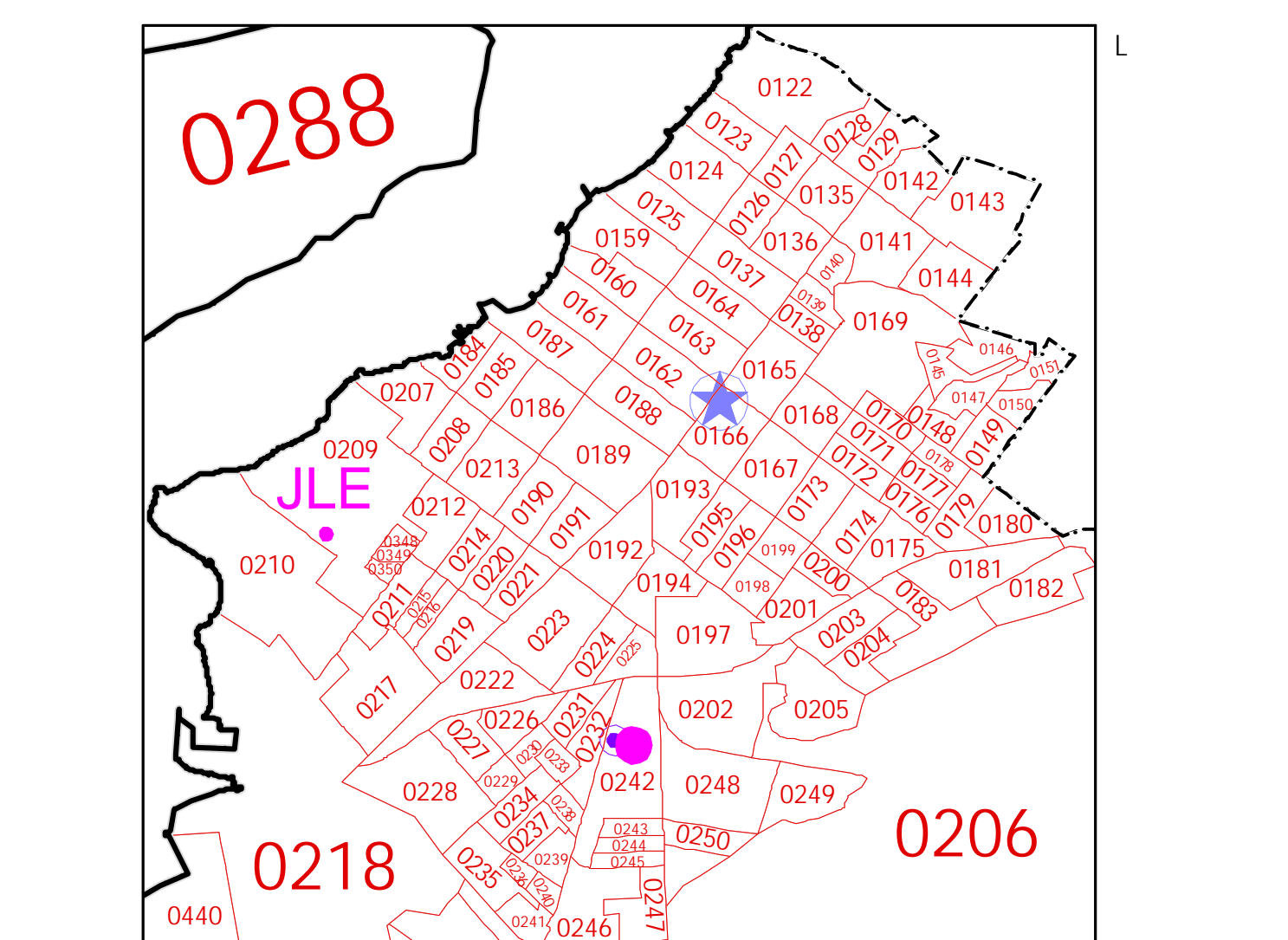
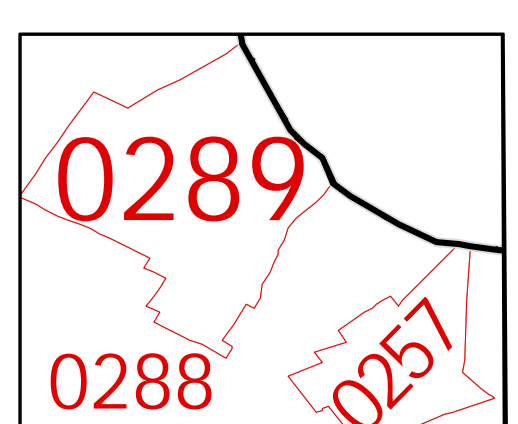
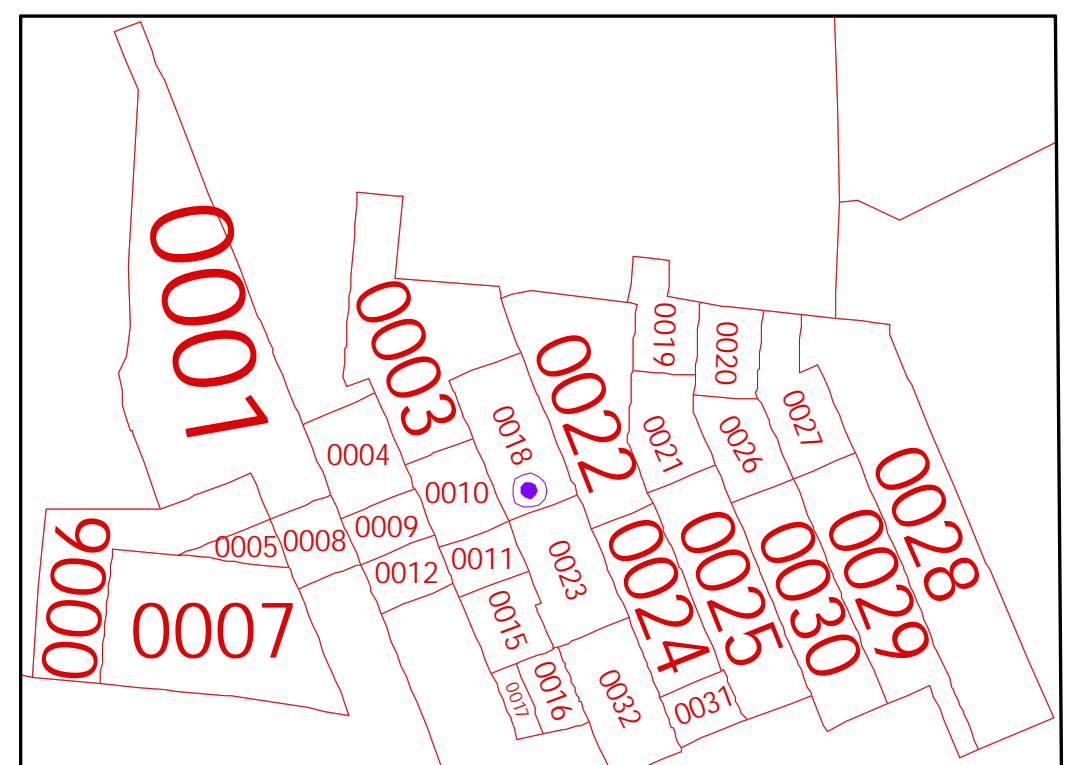
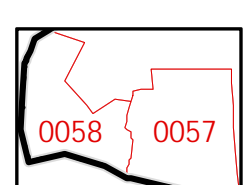
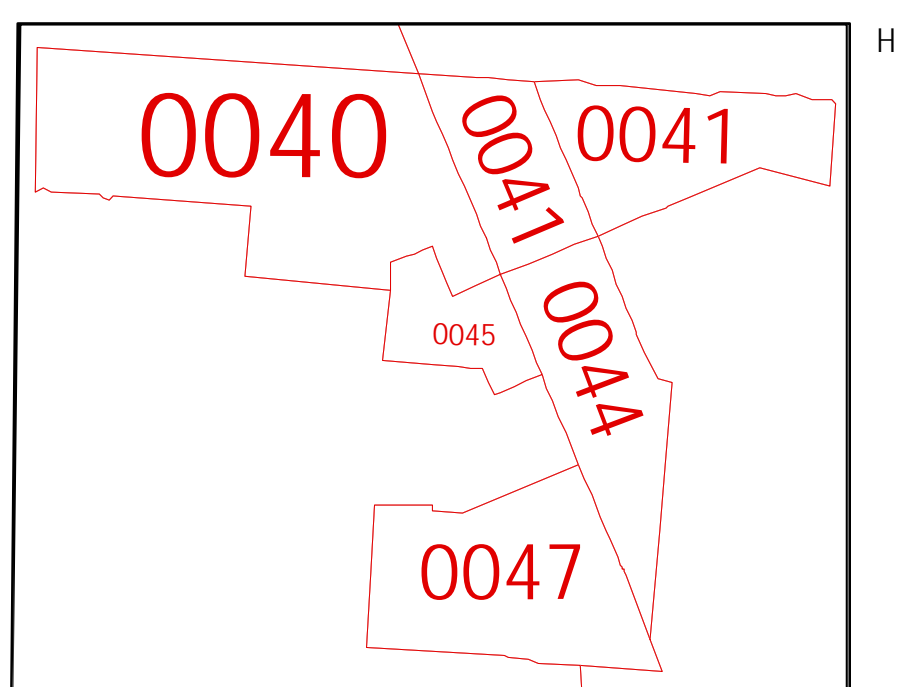
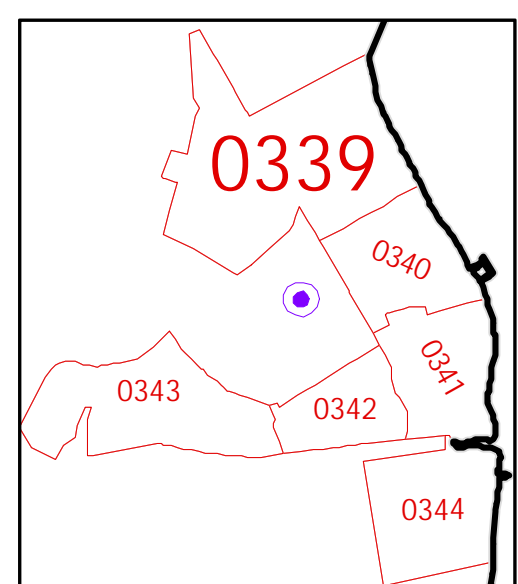
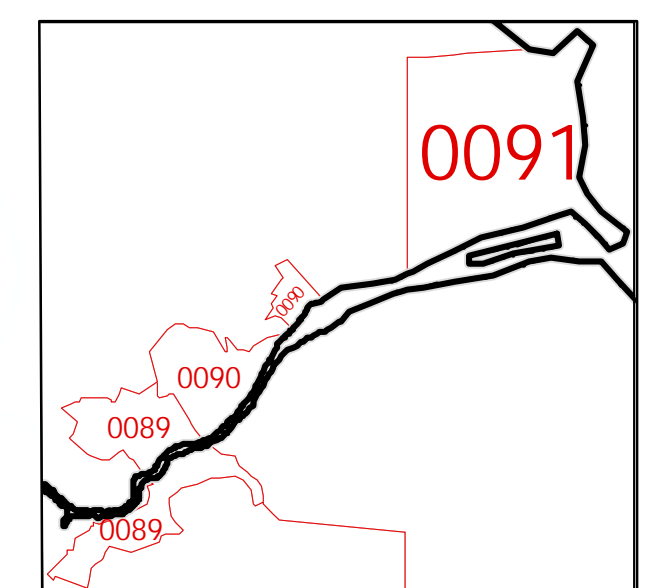
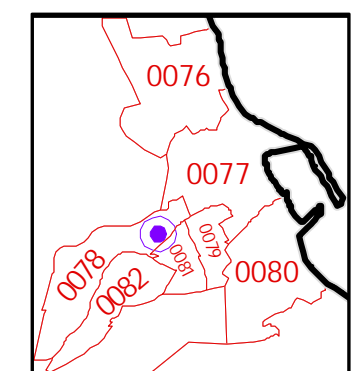
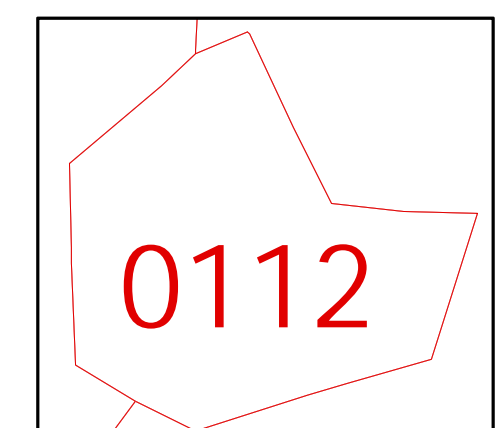
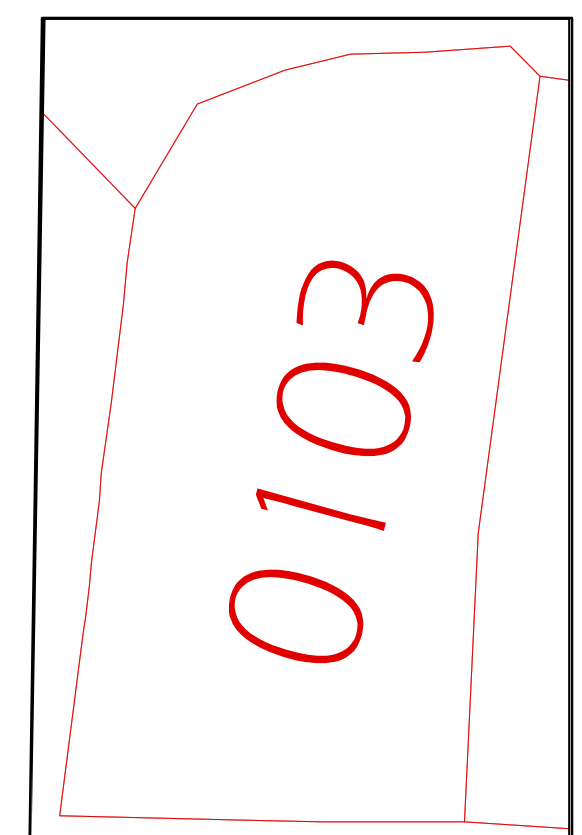
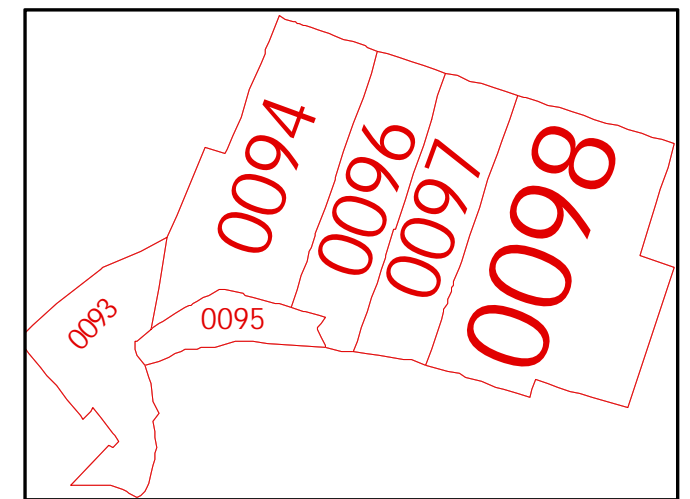
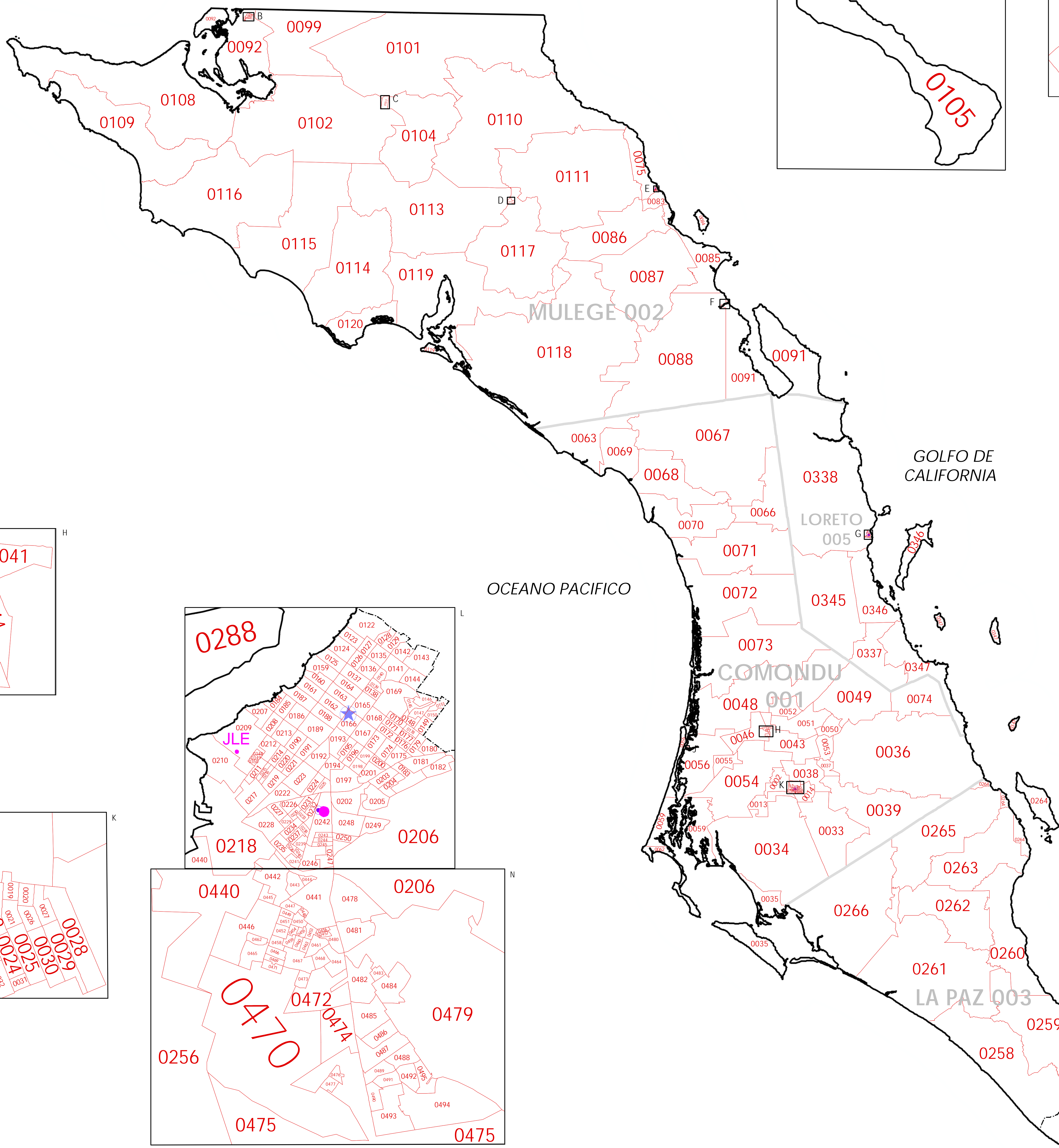

INSTITUTO NACIONAL ELECTORAL
 REGISTRO FEDERAL DE ELECTORES
 COORDINACIÓN DE OPERACIÓN EN CAMPO
 DIRECCIÓN DE CARTOGRAFÍA ELECTORAL

SIMBOLOGÍA

LÍMITES

INTERNACIONAL	---
ESTATAL	---
DISTRITAL FEDERAL	---
DELEGACIONAL Y/O MUNICIPAL	---
SECCIONAL	---

CLAVES GEOELECTORALES

DISTRITO ELECTORAL FEDERAL	00
MUNICIPIO	000
SECCIÓN	0000

CABECERAS

CAPITAL DEL ESTADO	★ JLE
VOCALIA ESTATAL	★
CABECERA DISTRITAL	●
CABECERA DE MUNICIPIO	●

UBICACIÓN DE LA ENTIDAD EN EL PAIS



UBICACIÓN DEL DISTRITO EN LA ENTIDAD

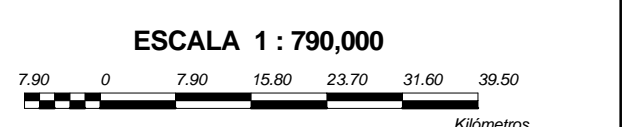
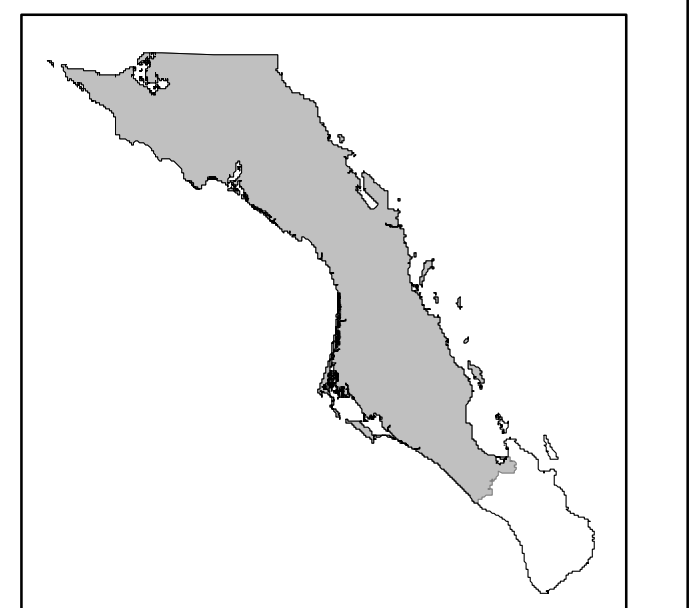

PLANO DISTRITAL SECCIONAL

IDENTIFICACIÓN ELECTORAL

ENTIDAD:	BAJA CALIFORNIA SUR	03
DISTRITO ELECTORAL FEDERAL:		01
TOTAL DE SECCIONES:		317
TOTAL DE MUNICIPIOS:		4

DISTRITO 02
 LA PAZ 003